

Philip Laney & Jolly



Building Plot, Court Road, Strensham, Worcestershire

- Building Plot in Village Location
- Planning Approval for 3 bedroom detached dwelling with garage
- Established residential neighbourhood

Guide Price: Offers in excess of £140,000

21 Worcester Road Great Malvern Worcestershire WR14 4QY
www.philiplaneyjolly.co.uk 01684 575100

Building Plot Court Road Strensham Worcestershire WR8 9LP

LOCATION/DESCRIPTION

A Building Plot with Planning Permission granted for a proposed three bedroom detached dwelling with garage within the sought after village of Strensham. Planning number W/07/02104/PN. Plans and conditions are available for inspection at our Malvern office.

VIEWING

Strictly by arrangement with the Agents. Please ring us to make an appointment. We are open from 9am to 5.30 pm Monday to Friday and 9am to 4pm on Saturdays.

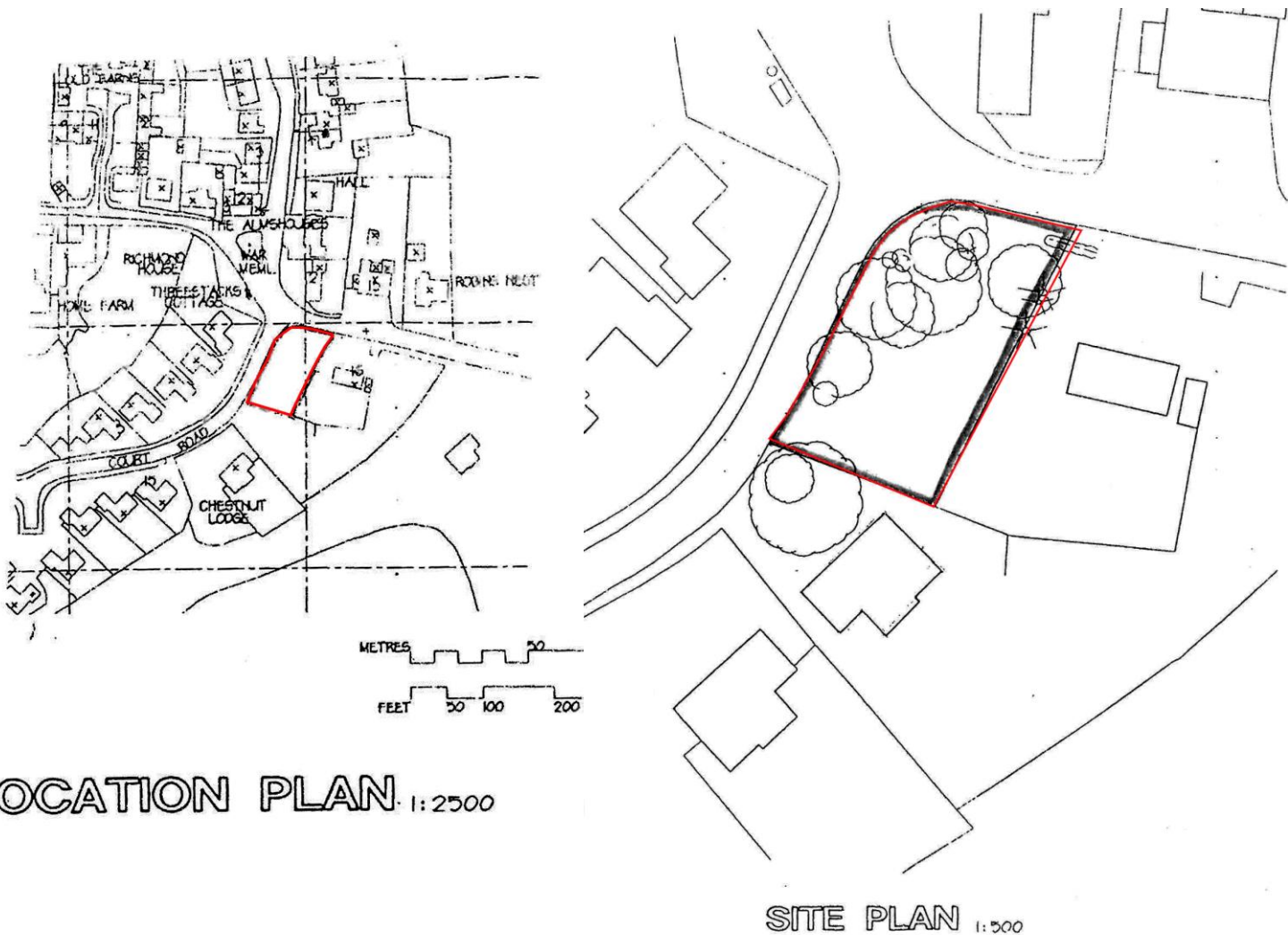

LOCATION PLAN 1:2500

SITE PLAN 1:500

The particulars are set out as a general outline only for the guidance of intended purchasers or lessees, and do not constitute, any part of a contract. Nothing in these particulars shall be deemed to be a statement that the property is in good structural condition or otherwise nor that any of the services, appliances, equipment or facilities are in good working order. Purchasers should satisfy themselves of this prior to purchasing. The photograph(s) depict only certain parts of the property. It should not be assumed that any contents/furniture etc. photographed are included in the sale. It should not be assumed that the property remains as displayed in the photograph(s). No assumption should be made with regard to parts of the property that have not been photographed. Any areas, measurements, aspects or distances referred to are given as a GUIDE ONLY and are NOT precise. If such details are fundamental to a purchase, purchasers must rely on their own enquiries. Descriptions of the property are subjective and are used in good faith as an opinion and NOT as a statement of fact. Please make further inquiries to ensure that our descriptions are likely to match any expectations you may have.

